

BELLEVUE CHRISTIAN THREE POINTS MAP

8-21-08

 Power Company Shut-Off

Pick-Up/Drop-Off Driveway

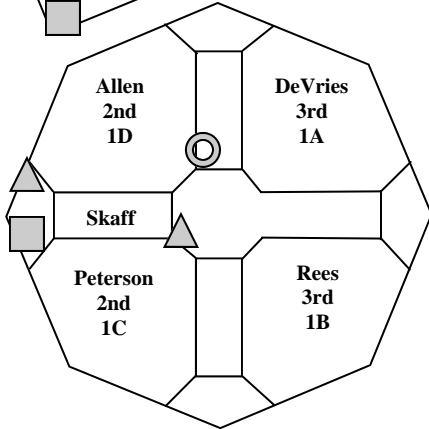
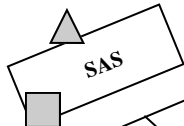
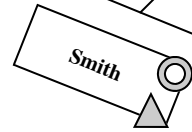
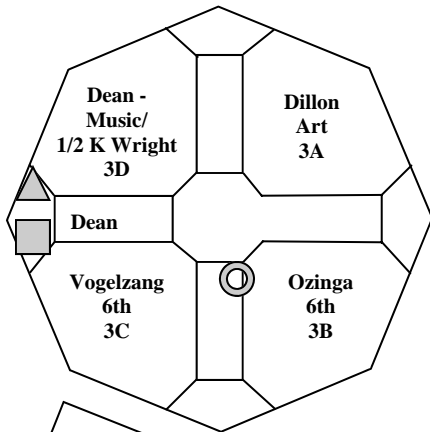

 School Electrical Shut-Off

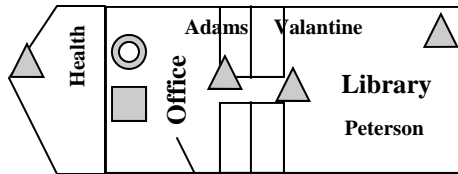

 6" Water Shut-Off For entire School

Principal: Steve Kennedy
 Counselor: Laura Carlson
 Admin Asst: Carol Hendricks
 Office Asst: Sue VerGowe

 =Water Shut-Off

 =Fire Extinguisher

 =Electrical Shut-Off

West ↑

Covered Walkway

East ↓

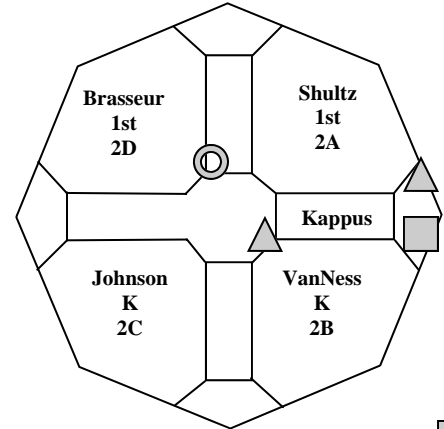
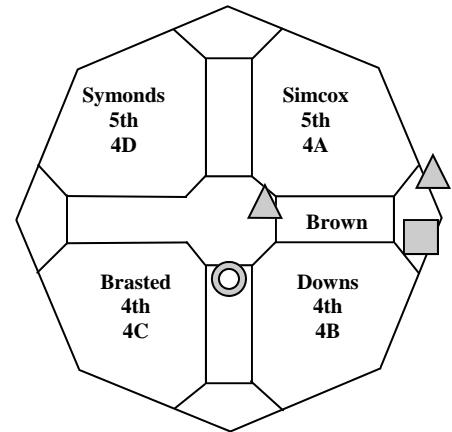

 Junction Box

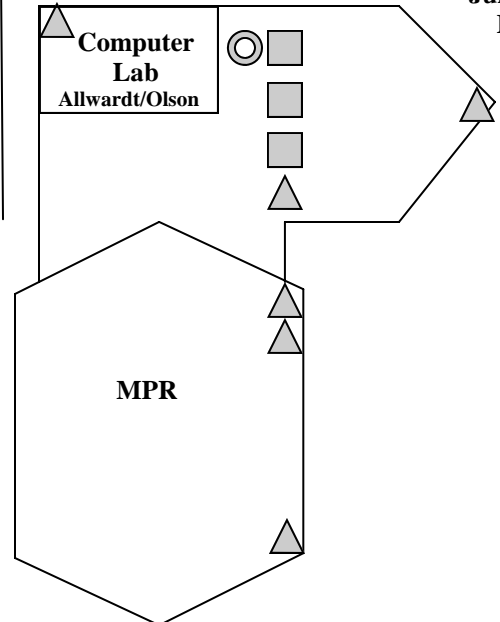

CAMPUS MAP-WATER/ELECTRICAL SHUT-OFF AND FIRE EXTINGUISHERS